

WIRELESS INDUSTRIAL MODEM



WIRELESS INDUSTRIAL MODEM

With the new range of wireless modem SENECA offers GSM, GPRS, and 3G Quadband equipment, ideal for industrial and professional use. Applications range include automation, remote control, M2M telemetry connections, data transfer from/to each type of installation.

The SENECA wireless modem run remote applications of any serial device. Equipped with RS232 or Micro USB and Vac / dc power supply, they support data transfer via TCP / IP Socket in a compact and rugged design for DIN rail mounting.

Z-MODEM QUADBAND GSM/GPRS INDUSTRIAL MODEM WITH RS232 SERIAL PORT

GSM / 2G
Quad-Band GSM
850 MHz, EGSM
900MHz, DCS 1800
MHz, PCS 1900 MHz

GSM

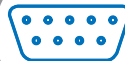

**RS232 Serial
Communication**

TCP-IP

**Embedded
Protocols**
TCP-IP (ftp, Smtp,
Pop3, http)

GPRS

GPRS
Downlink max 85.6
kbps, uplink max
42.8 kbps



**Standard SIM
25 x15 mm**

**LED Status
indicators**



**1,5 kVac
galvanic
isolation**



**Fast mounting and
removing on
DIN 46277 rail**



DATA TRANSMISSION BY MODEM WITH PLC SERIAL CONNECTION

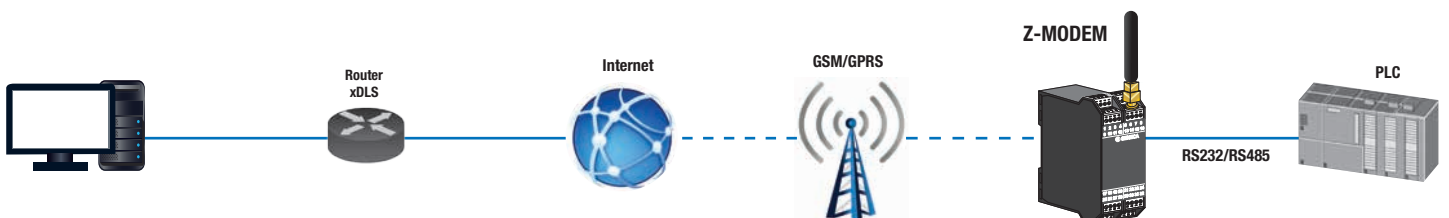

WIRELESS INDUSTRIAL MODEM

Z-MODEM-3G 3G INDUSTRIAL MODEM WITH MICRO USB INTERFACE

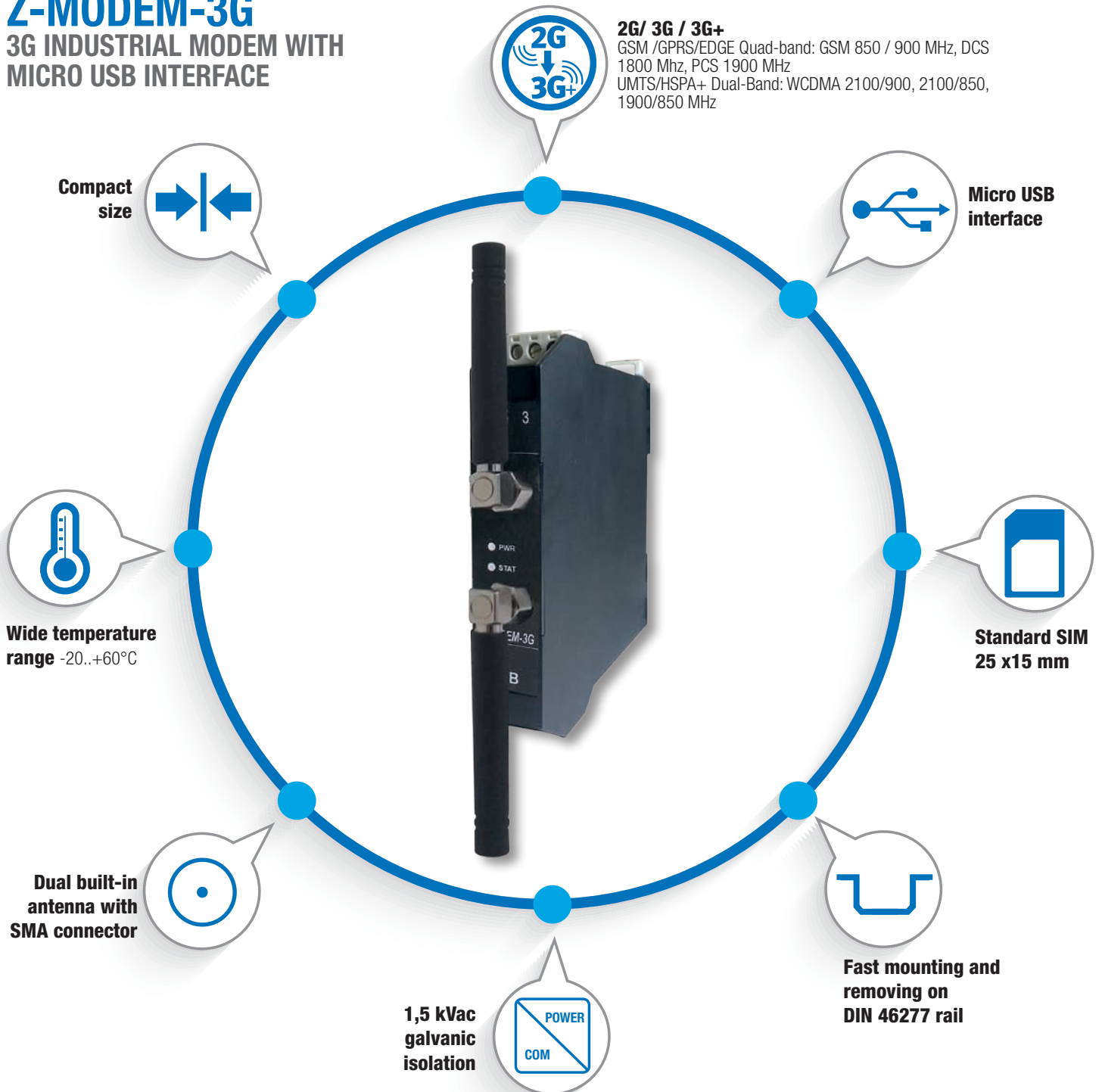

DATA TRANSMISSION BY MODEM WITH USB CONNECTION TO Z-TWS4/Z-PASS1

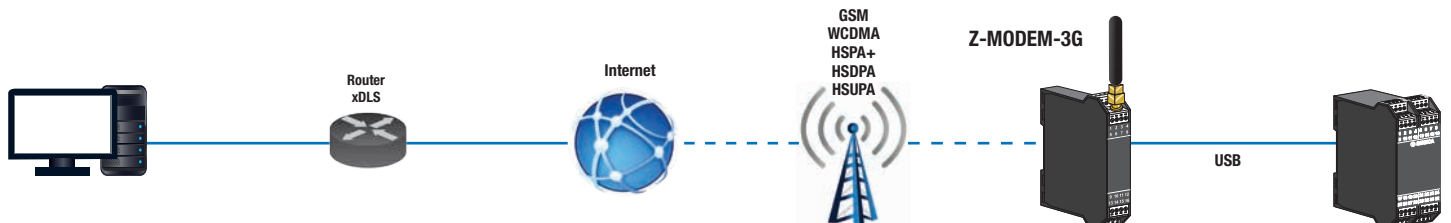

WIRELESS INDUSTRIAL MODEM

TECHNICAL FEATURES

Z-MODEM



Quadband GSM/GPRS industrial modem
with RS232 serial port

Z-MODEM-3G



3G industrial modem
with micro USB interface

GENERAL DATA		
Power supply	10..40 Vdc; 19..28 Vac	10..40 Vdc; 19..28 Vac
Power consumption	2W (standby), 6.5 W (MAX)	2W (standby), 5 W (MAX)
Protection degree	IP20	IP20
Isolation	1.500 Vac power supply / RS232	1.500 Vac power supply / 3G USB
LED signalling	Power, communication	Power, communication
Antenna connector	SMA type	SMA type
SIM card	Standard (25 x15 mm)	Micro SIM @ 3V con connettore push pull
Dimension	100x 112 x 35 (l x h x p)	100x 112 x 17.5 (l x h x p)
Mounting	Fast mounting for DIN rail 46277	Fast mounting for DIN rail 46277
Connection	Removable terminals for conductors up to 2,5 mm ²	Removable terminals for conductors up to 2,5 mm ²
Operating Temperature	-20..+60°C	-20..+60°C
Material, color	PBT, black	PBT, black
Dimension	100 x 35 x 112 mm	100 x 17,5 x 112 mm
Weight	280 g	225 g
COMMUNICATION		
Serial Interface	RS232 IDC10 side	
USB		Micro USB
Modem frequency	Quad-Band GSM 850 MHz, EGSM 900MHz, DCS 1800 MHz, PCS 1900 MHz	GSM /GPRS/EDGE Quad-band: GSM 850 / 900 MHz, DCS 1800 Mhz, PCS 1900 MHz UMTS/HSPA+ Dual-Band: WCDMA 2100/900, 2100/850, 1900/850 MHz
Embedded protocols	TCP/IP, ftp, Smtip, Pop3, http	
Connection rate	Downlink max 85.6 kbps, Uplink max 42.8 kbps	Downlink max 14.4 Mbps, Uplink max 5.76 Mbps
STANDARD		
Certifications	CE	CE
Norms	EN 61000-6-4, EN 61000-6-2, EN 301511, EN 301489-1, EN 301489-7, EN 60950	FCC part 15 class B, EN 55024, EN 301511, EN 301489-7, EN 301489-1, EN 60950

ORDER CODES

Code	Description
Z-MODEM	Quadband GSM/GPRS industrial modem with RS232 serial port
Z-MODEM-3G	3G industrial modem with micro USB interface

ACCESSORI

Code	Description	Z-MODEM	Z-MODEM-3G
A-GSM	Dual band swing GSM external antenna, cable 3,2 m, SMA	X	X
CU-A-MICROB	USB-A Micro USB-B 5 P cable		X
CS-DB9M-DB9F	RS232 (DB9M / DB9F) serial cable	X	
CS-DB9F-CFV10	RS232 (DB9F-CFV10) serial cable with adapter	X	
Z-PC-DINAL1-35	DIN rail bus system head terminal + 1 slot 35 mm	X	
Z-PC-DIN1-35	DIN rail bus system 1 slot 35 mm	X	
Z-PC-DINAL2-17.5	DIN rail bus system head terminal + 2 slots 17.5 mm		X
Z-PC-DIN2-17.5	DIN rail bus system 2 slots 17.5 mm		X



Via Austria, 26 • 35127 Padova - (I)
Tel. +39 049 87.05.359 • Fax +39 049 87.06.287
www.seneca.it • info@seneca.it